

MIG/MAG

The image features several technical line drawings of welding equipment. At the top is a large MIG/MAG torch. Below it, there are drawings of various torch components, including a nozzle, a contact tip, and a spray gun. The drawings are rendered in a light gray color against a dark gray background. On the left side, there are blue diagonal stripes. At the bottom, there is a blue logo for ERGODANI and a blue horizontal bar containing the text 'TECHNICAL SHEETS'.

NEO UNIVERSAL RANGE

TECHNICAL SHEETS

Edic 2014. Ref01



F O R A D V A N C E D W E L D E R S



GAS COOLED

180 Amp 60% CO₂

164 Amp 60% Ar+CO₂

Universal spare part range, the lowest intensity model in the range but very lightweight.

Low ampere model for small repairs and general use, ideal for 0.8 wire and small pieces because of its small size and easy handling.

It features a small diameter model for welding in areas with difficult access.

EN 15

TECHNICAL SHEET ADVANTEGES

LONG WORKING LIFE TRIGGER, WITH SILVER-COATED CONTACTS.



EXTRA FLEXIBLE, OVER-DIMENSIONED POWER CABLE, HEATING OF THE WELDING GUN IS REDUCED THUS LENGTHENING ITS USEFUL LIFE.

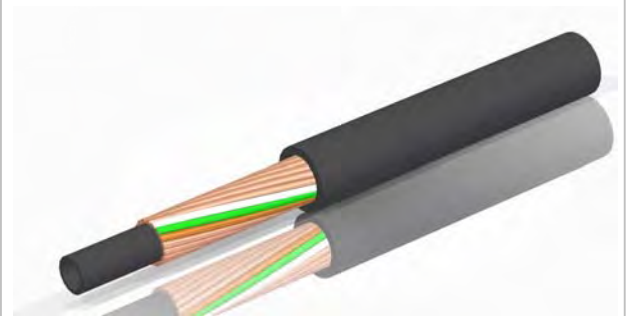

HIGH QUALITY EUROPEAN CONTACT TIP ISO Cu-ETP/CuCrZr.



**MADE
IN
EUROPE**
According to ISO Cu-ETP/CuCrZr
**COBRE EUROPEO
MECANIZADO EN FINLANDIA
EUROPEAN COOPER
TURNING IN FINLAND**

ERGONOMIC DESIGNED HANDLE TO AVOID REPETITIVE STRAIN INJURIES DURING PROLONGED USE.



F O R A D V A N C E D W E L D E R S



ERGOWELD S.L. - C/bancalets, 19 - C.P.46530 - PUZOL (Valencia -Spain)- Tel:0034 961 114 007 - info@ergoweld.es



GAS COOLED

230 Amp 60% CO₂

209 Amp 60% Ar+CO₂

Universal spare part range, this is the medium intensity model and the most versatile of its type in the range.

It features a medium diameter nozzle with multiple diameter possibilities for gas output.

Medium ampere model for general use, ideal for 0.8 and 1.0 wire, repairs to thin / medium thicknesses, multipurpose for spot welding parts and small welding beads.

EN 25

TECHNICAL SHEET ADVANTEGES

LONG WORKING LIFE TRIGGER, WITH SILVER-COATED CONTACTS.



EXTRA FLEXIBLE, OVER-DIMENSIONED POWER CABLE, HEATING OF THE WELDING GUN IS REDUCED THUS LENGTHENING ITS USEFUL LIFE.

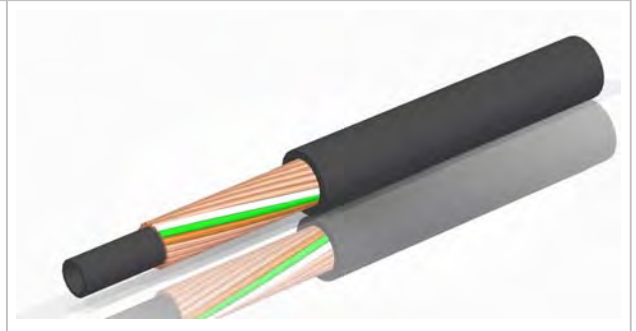

HIGH QUALITY EUROPEAN CONTACT TIP ISO Cu-ETP/CuCrZr.



**MADE
IN
EUROPE**
According to ISO Cu-ETP/CuCrZr
**COBRE EUROPEO
MECANIZADO EN FINLANDIA
EUROPEAN COOPER
TURNING IN FINLAND**

WIDER NOZZLES FOR EXTENDING THE WORKING LIFE.

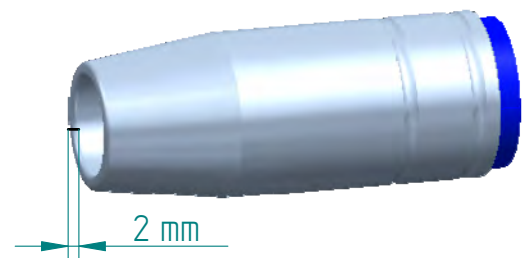

ERGONOMIC DESIGNED HANDLE TO AVOID REPETITIVE STRAIN INJURIES DURING PROLONGED USE.

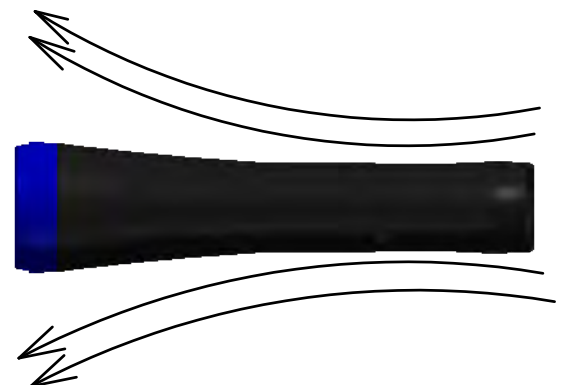

F O R A D V A N C E D W E L D E R S





GAS COOLED

250 Amp 60% CO₂

228 Amp 60% Ar+CO₂

Universal spare part model, this is the medium intensity, lightweight, high power model.

It has small diameter nozzles that permit access to specific applications whilst maintaining the relatively high power for its small size.

Medium ampere model for general use, ideal for 0.8 and 1.2 wire, repairs to thin / medium thicknesses, multipurpose for spot welding parts and small welding beads.

EN 24

TECHNICAL SHEET ADVANTEGES

LONG WORKING LIFE TRIGGER, WITH SILVER-COATED CONTACTS.



EXTRA FLEXIBLE, OVER-DIMENSIONED POWER CABLE, HEATING OF THE WELDING GUN IS REDUCED THUS LENGTHENING ITS USEFUL LIFE.

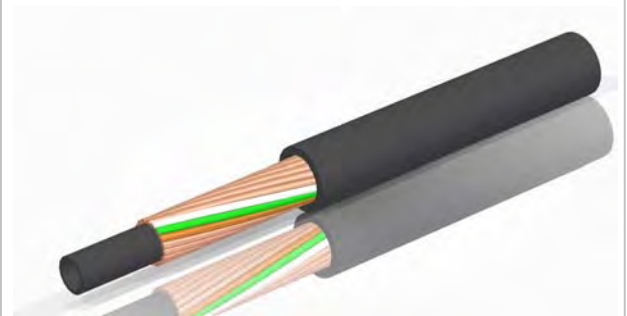

HIGH QUALITY EUROPEAN CONTACT TIP ISO Cu-ETP/CuCrZr.



**MADE
IN
EUROPE**
According to ISO Cu-ETP/CuCrZr
**COBRE EUROPEO
MECANIZADO EN FINLANDIA
EUROPEAN COOPER
TURNING IN FINLAND**

ERGONOMIC DESIGNED HANDLE TO AVOID REPETITIVE STRAIN INJURIES DURING PROLONGED USE.



F O R A D V A N C E D W E L D E R S



ERGOWELD S.L. - C/bancalets, 19 - C.P.46530 - PUZOL (Valencia -Spain)- Tel:0034 961 114 007 - info@ergoweld.es

EN 36

TECHNICAL SHEET



GAS COOLED

340 Amp 60% CO₂

309 Amp 60% Ar+CO₂

Universal spare part model, this is the relatively high intensity model with the limitations of a gas cooled welding torch.

Medium ampere model for general purpose use, ideal for 1.0 and 1.2 wire, for welding medium thickness parts, multipurpose for spot welding and major thickness welds.

It features a long, large size nozzle with multiple options for gas output diameters.

EN 36

TECHNICAL SHEET ADVANTEGES

LONG WORKING LIFE TRIGGER, WITH SILVER-COATED CONTACTS.



EXTRA FLEXIBLE, OVER-DIMENSIONED POWER CABLE, HEATING OF THE WELDING GUN IS REDUCED THUS LENGTHENING ITS USEFUL LIFE.

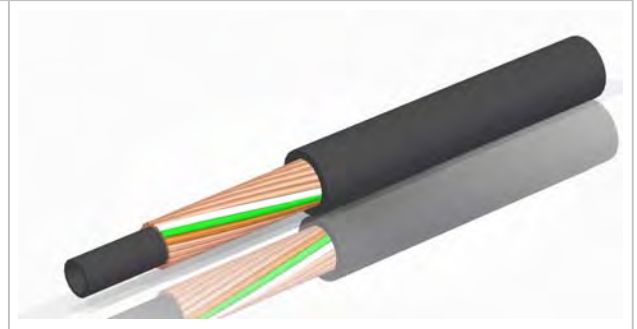

HIGH QUALITY EUROPEAN CONTACT TIP ISO Cu-ETP/CuCrZr.



WIDER NOZZLES FOR EXTENDING THE WORKING LIFE.

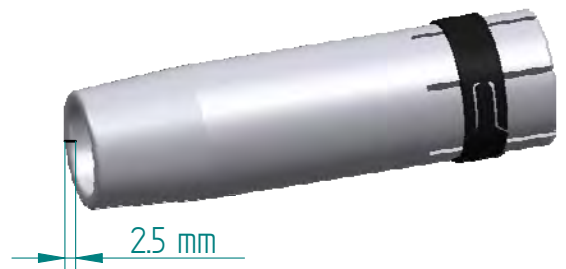

ERGONOMIC DESIGNED HANDLE TO AVOID REPETITIVE STRAIN INJURIES DURING PROLONGED USE.

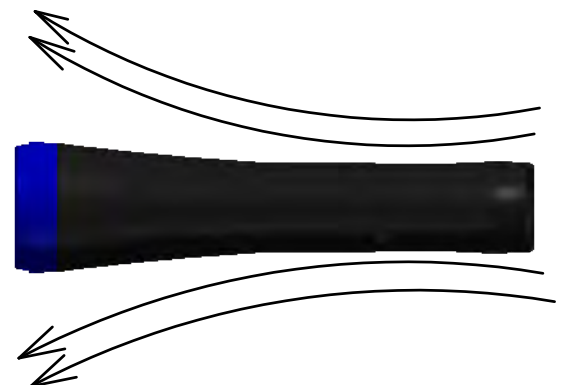

F O R A D V A N C E D W E L D E R S



ERGOWELD S.L. - C/bancalets, 19 - C.P.46530 - PUZOL (Valencia -Spain)- Tel:0034 961 114 007 - info@ergoweld.es

EN 240W

TECHNICAL SHEET



LIQUID COOLED

300 Amp 100% CO₂

273 Amp 100% Ar+CO₂

Universal spare part range, lightweight, liquid-cooled model providing extra power to gas-cooled equivalent model EN-24, whilst maintaining its small size.

Medium ampere model for medium power welding requirements, ideal for 1.0 to 1.2 wire and complex welds thanks to its light weight and easy handling.

It has a small diameter nozzle enable access to specific applications, whilst maintaining relatively high power for its small size.

EN 240w

TECHNICAL SHEET ADVANTEGES

LONG WORKING LIFE TRIGGER, WITH SILVER-COATED CONTACTS.



POWER CABLE ASSEMBLY DESIGNED WITH DIELECTRIC RUBBER AND REINFORCED WITH POLYAMIDE MESH.

COPPER BRAID INSIDE, EXTRA FLEXIBLE WITH 0.10 MM FILAMENTS. THE GUARANTEE AGAINST BREAKAGE.



HIGH QUALITY EUROPEAN CONTACT TIP ISO Cu-ETP/CuCrZr.



NEW WIDER DIAMETER KNUCLE AND SHEATH HOLDING SYSTEM WITHOUT DIAMETER CHANGES, MEANING WIDER FREEDOM OF MOVEMENT WITHOUT PINCHING THE COOLING SYSTEM

ERGONOMIC DESIGNED HANDLE TO AVOID REPETITIVE STRAIN INJURIES DURING PROLONGED USE..



EN 501W

TECHNICAL SHEET



LIQUID COOLED

500 Amp 100% CO₂

455 Amp 100% Ar+CO₂

CE

Universal spare part range, one of the most powerful liquid cooled in the range, featuring exceptional quality and finish.

It features a medium size nozzle in spite of being a high power welding torch, and is very light and versatile.

High ampere model for powerful welding, ideal for 1.2 and 1.6 welding rods and thick pieces where welding power is a determining factor.

EN 501w

TECHNICAL SHEET ADVANTEGES

LONG WORKING LIFE TRIGGER, WITH SILVER-COATED CONTACTS.



POWER CABLE ASSEMBLY DESIGNED WITH DIELECTRIC RUBBER AND REINFORCED WITH POLYAMIDE MESH.



COPPER BRAID INSIDE, EXTRA FLEXIBLE WITH 0.10 MM FILAMENTS. THE GUARANTEE AGAINST BREAKAGE.

HIGH QUALITY EUROPEAN CONTACT TIP ISO Cu-ETP/CuCrZr.



WIDER NOZZLES FOR EXTENDING THE WORKING LIFE.

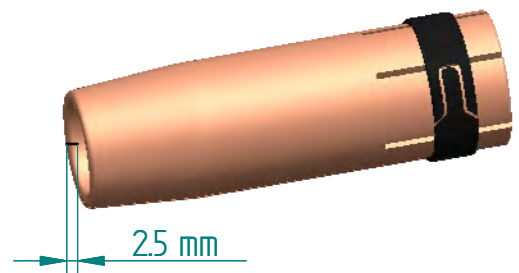

NEW WIDER DIAMETER KNUCLE AND SHEATH HOLDING SYSTEM WITHOUT DIAMETER CHANGES, MEANING WIDER FREEDOM OF MOVEMENT WITHOUT PINCHING THE COOLING SYSTEM

ERGONOMIC DESIGNED HANDLE TO AVOID REPETITIVE STRAIN INJURIES DURING PROLONGED USE..





F O R A D V A N C E D W E L D E R S

ERGOWELD S.L.- C/bancalets, 19 - C.P.46530 - PUZOL (Valencia -Spain)- Tel:0034 961 114 007 - info@ergoweld.es

www.ergodani.com

TECHNICAL SHEETS